

SECTION 7

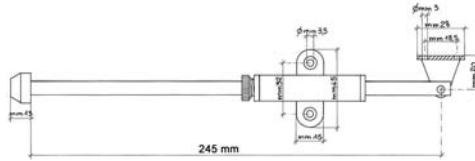

SUPPORTS, BRACKETS & FITTINGS

LID SUPPORTS

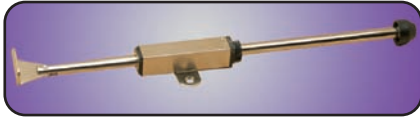

0850.245.044 CHROME/BLACK

- Lift-up lid support
- Provides soft closing or can hold lid in position
- Ideal for storage boxes and chests
- Friction type, side mounted
- Adjustable tension for weight variance
- Material: Steel
- Packaging: 25 pieces

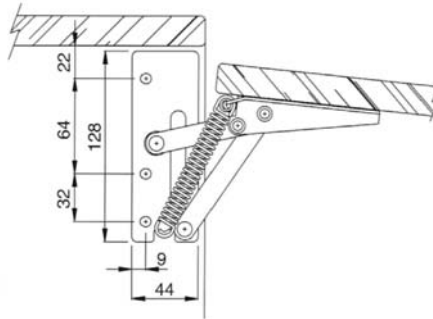

3220.001.157 WHITE/CHROME

- Lift-up lid support
- Ideal for overhead storage cabinet
- 75° opening
- Spring on right side only
- Material: Steel
- Packaging: 50 pair

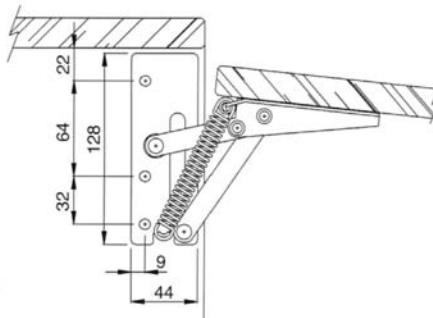

3221.002.157 WHITE/CHROME

- Lift-up lid support
- Ideal for overhead storage cabinet
- 75° opening
- Spring on right and left side
- Material: Steel
- Packaging: 50 pair

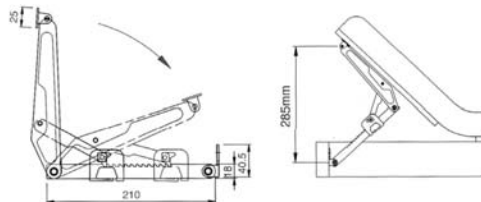

4049.003.098 ZINC PLATED

- Ratchet mechanism support
- Ideal for drafting tables, foot and head rests
- 12 position adjustment
- Material: Steel
- Packaging: 50 pieces

LID SUPPORTS

CONTINUED

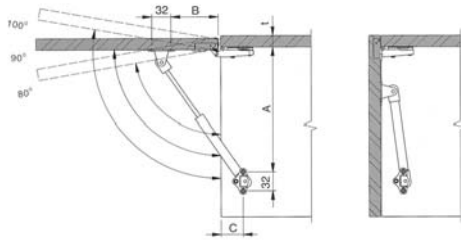

7870.004.040 MATTE CHROME/CHROME

- Gas lift-up lid mechanism
- Ideal for all types of overhead storage
- Soft opening action from 80-100 degrees
- Material: Steel
- Packaging: 250 pieces (R&L interchangeable)

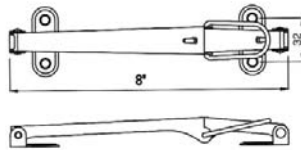

1509.080

- Drop leaf supports with finger pull
- Material: Steel
- Finish: Zinc, AC Plated or Black Coated

BED FITTINGS

BED AND K/D CONNECTORS

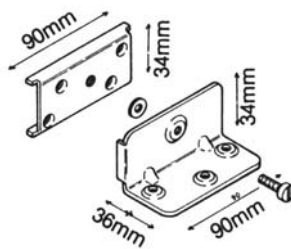
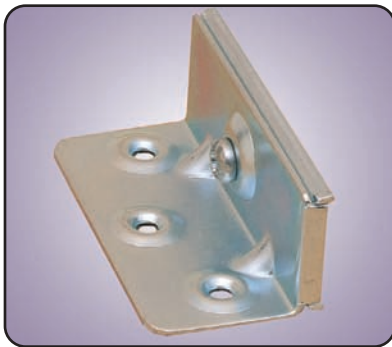

8055.001.098 ZINC

- Heavy duty 2-piece fitting
- Single screw creates positive lock
- Material: 2 mm thick steel
- Packaging: 250 sets

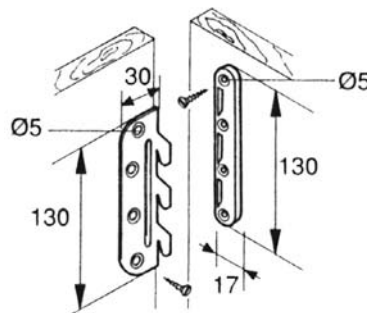

8056.002.097 YELLOWED STEEL

- Heavy duty 2-piece fitting
- Lift off feature
- Material: 1.5 mm thick steel
- Packaging: 10 sets

SHELF SUPPORTS

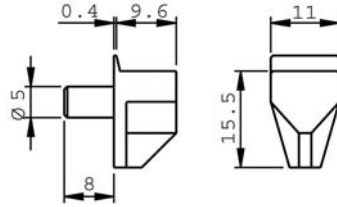
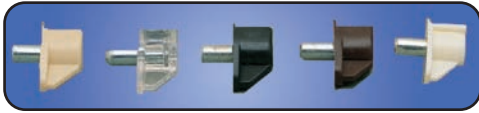

PLASTIC SUPPORT WITH STEEL PIN

- 5 mm Ø
- Suitable for glass and wood
- Zinc plated steel pin with secure bond to plastic support
- Packaging: 5,000 pcs

ARTICLE

8006.002.061
8007.002.067
8008.002.060
8009.002.448
8010.002.004

COLOR

White
Brown
Black
Almond
Clear

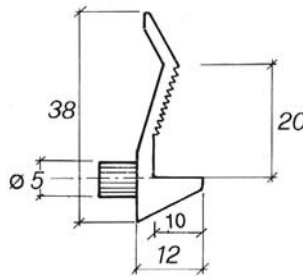
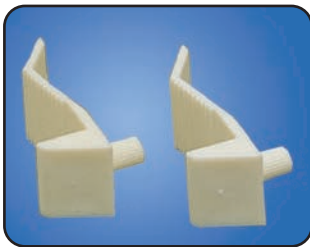

SECURING SHELF SUPPORT

- 5 mm Ø
- Accommodates shelves from 12-20 mm
- Material: Nylon
- Packaging: 1,000 pcs

ARTICLE

8011.002.061

COLOR

White

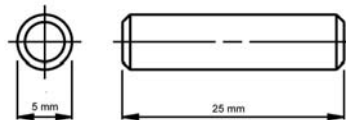

STEEL PIN SUPPORT

- 5 mm Ø
- Strong versatile support
- Material: Steel
- Packaging: 1,000 pcs

ARTICLE

8017.002.060

COLOR

Black

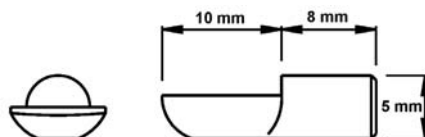

METAL SPOON SUPPORT

- 5 mm Ø
- Material: Steel
- Packaging: 1,000 pcs

ARTICLE

8015.002.014
8016.002.019

FINISH

Nickel
Brass

SHELF SUPPORTS

CONTINUED

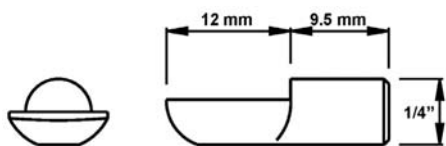

METAL SPOON SUPPORT

- 1/4" Ø
- Material: Steel
- Packaging: 1,000 pcs

ARTICLE #	FINISH
8018.001.014	Nickel
8019.001.019	Brass

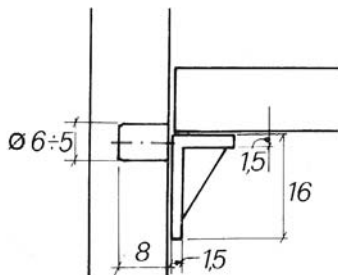

NYLON SHELF SUPPORTS

- 5 mm Ø
- Suitable for glass and wood
- Ribbed pin for positive hold
- Material: Nylon
- Packaging: 1,000 pcs

ARTICLE #	COLOR
8021.002.061	White
8022.002.060	Black
8024.002.023	Brown

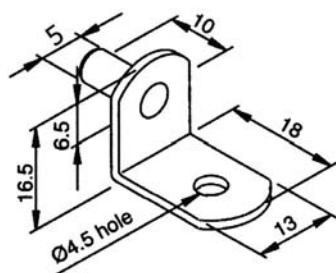

METAL SHELF SUPPORT

- 5 mm Ø
- Screw hole for securing shelf
- Material: Steel
- Packaging: 2,500 pcs

ARTICLE #	FINISH
8030.002.014	Nickel
8031.002.019	Brass
8032.002.023	Ant. Copper

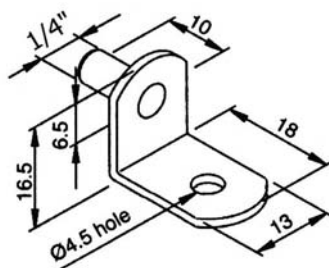

METAL SHELF SUPPORT

- 1/4" Ø
- Screw hole for securing shelf
- Material: Steel
- Packaging: 2,500 pcs

ARTICLE #	FINISH
8033.001.014	Nickel
8034.001.019	Brass
8035.001.023	Ant. Copper

SHELF SUPPORTS & BUMPERS

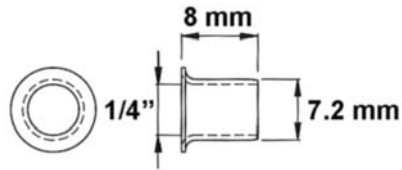

SHELF SUPPORT SLEEVE

- For 1/4" Ø support
- Reinforces shelf pin hole
- Material: Steel
- Packaging: 1,000 pcs

ARTICLE #
8271.011.104

FINISH
Nickel

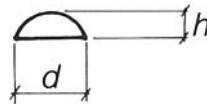

SELF ADHESIVE BUMPER

- Cushions door and drawer closing
- Creates non-skid surface
- Material: Soft rubber
- Packaging: 5,000 pieces (2,500 for 8026.003.004)

ARTICLE #
8025.001.004
8026.003.004
8027.002.004

DIAMETER X H
10 x 3 mm
7 x 1.5 mm
10 x 1.5 mm

FINISH
Clear
Clear
Clear

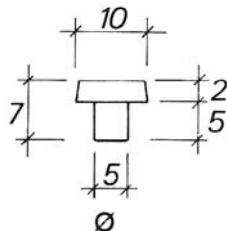

SOFT INSERT BUMPER

- Cushions door and drawer closing
- Creates non-skid surface
- Material: Soft rubber
- Packaging: 10,000 pcs

ARTICLE #
8028.001.004

FINISH
Clear

SHELF BRACKETS

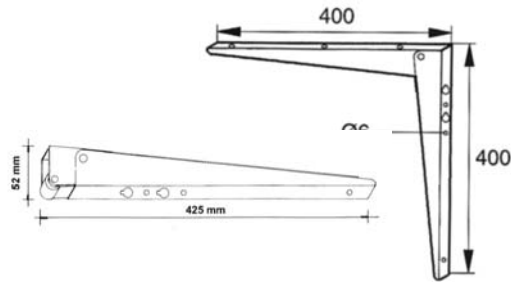

HEAVY DUTY FOLDING BRACKET

- Ideal for collapsible work surface
- Keyhole mounting to wall
- Weight capacity: 154 lbs. per pair
- Material: Steel
- Packaging: 15 pairs

ARTICLE #
0466.400.097

FINISH
Yellowed Steel

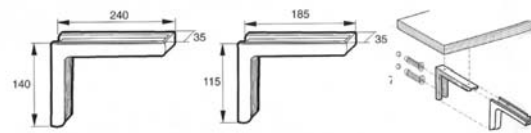

SHELF BRACKET WITH PLASTIC COVER

- Decorative design
- Mounting hardware included
- Weight capacity: 110 lbs. per pair
- Material: Steel/Plastic
- Packaging: 1 pair

ARTICLE #	SIZE	FINISH
0452.185.061	115 x 185 mm	White
0452.185.067	115 x 185 mm	Brown
0452.240.061	140 x 240 mm	White

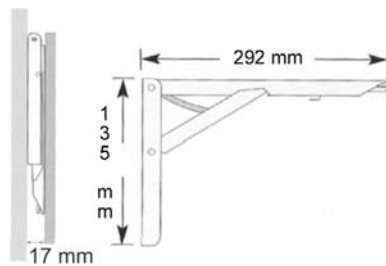

SELF-LOCK DROP LEAF SUPPORT

- Ideal for folding shelves or work surface
- Locks in place with spring release mechanism
- Powder coated
- Material: Steel
- Packaging: 1 pair visual pack

ARTICLE #
6577.292.067

FINISH
Brown

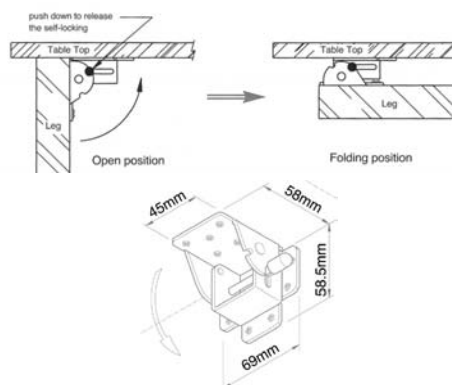
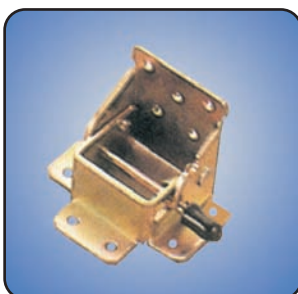

FOLDING BRACKET

- Ideal for tables, legs and shelves
- Self-locking with tension spring
- Material: 2.5 mm thick steel
- Packaging: 150 pieces

ARTICLE #
6850.001.097

FINISH
Yellowed Steel

CONNECTING FITTINGS

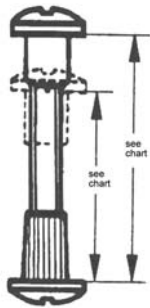

ARTICLE #	FINISH	PANEL THICKNESS
1218.028.010	Chrome	28-35 mm (1-1/8" - 1-3/8")
1219.032.155	Bronze	32-40 mm (1-1/4" - 1-3/4")
1220.032.010	Chrome	32-40 mm (1-1/4" - 1-3/4")
1221.032.019	Brass	32-40 mm (1-1/4" - 1-3/4")
1222.035.010	Chrome	35-43 mm (1-3/8" - 1-3/4")

- Ideal for securing 2 panels to join multiple units together
- Material: Steel
- Packaging: 4,000 pieces

*The above represent normally stocked items. Other size and finish combinations are available.

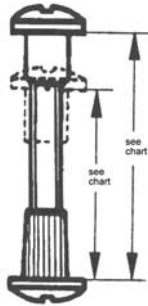

ARTICLE #	FINISH	PANEL THICKNESS
1234.028.067	Brown	28-38 mm (1-1/8" - 1-1/2")
1231.032.061	White	32-40 mm (1-1/4" - 1-9/16")
1230.035.061	White	35-53 mm (1-3/8" - 1-11/16")
1230.035.067	Brown	35-53 mm (1-3/8" - 1-11/16")
1232.035.060	Black	35-53 mm (1-3/8" - 1-11/16")
1228.056.061	White	56-62 mm (2-3/16" - 2-7/16")

- Ideal for securing 2 panels to join multiple units together
- Material: Steel screw with plastic end caps
- Packaging: 1,000 pieces

*The above represent normally stocked items. Other size and finish combinations are available.

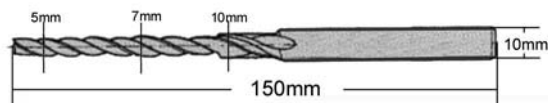

STEP DRILL BIT

1285.180.000

- 7 x 50 mm
- Material: Carbide tipped steel
- Packaging: 1 piece

CONNECTING FITTINGS

CONTINUED

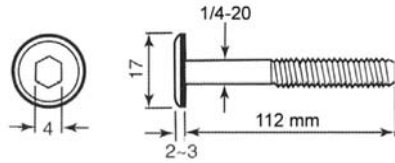

1131.112.023 ANTIQUE COPPER

- Joint connector bolt
- Other available finishes include:
Zinc, Black, and Brass
- Material: C1008 Steel
- Packaging: 450 pieces

* Additional styles, lengths and thread sizes are available

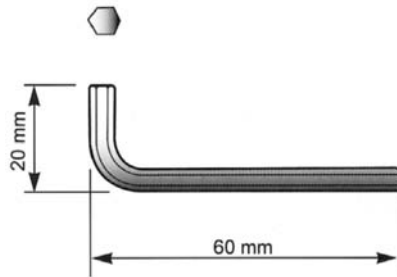

1094.004.098 ZINC

- L Hex allen key
- 4 mm
- Material: Hardened Steel
- Packaging: 2,000 pieces

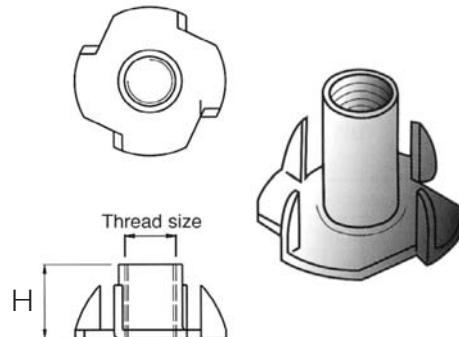
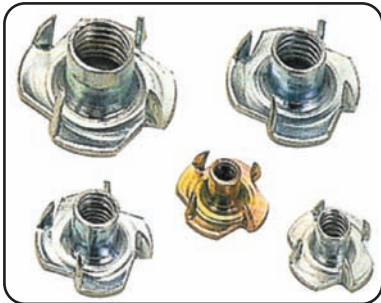

H = 11 mm for the 4090 H = 8.5mm for the 4093

4090.008.098 8MM THREAD 4093.142.098 1/4-20 THREAD

- T-nuts
- Material: Steel
- Packaging: 4090 = 1,000 pieces
4093 = 10,000 pieces

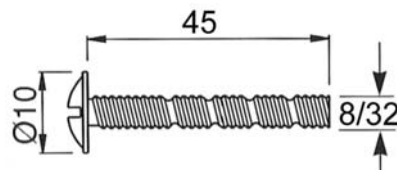
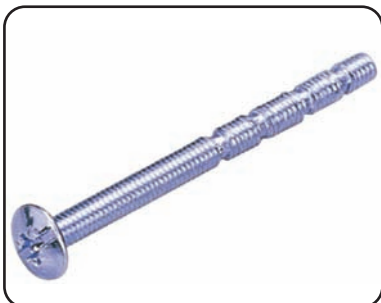

0134.045.098 ZINC PLATED

- Break-a-way machine screw
- 8/32 Thread
- Truss/Phillips slotted combination
- 4 breaks
- Material: C1018 Hardened Steel
- Packaging: 3,200 pieces

CONNECTING FITTINGS

CONTINUED

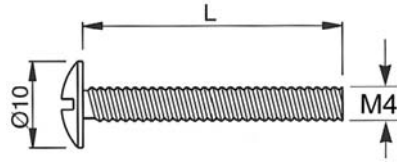

0420.020.098	20 MM L
0420.022.098	22 MM L
0420.025.098	25 MM L
0420.030.098	30 MM L
0420.035.098	35 MM L
0420.038.098	38 MM L
0420.040.098	40 MM L
0420.045.098	45 MM L
0420.050.098	50 MM L

- Metric machine screw
- M4 Thread
- Truss/Phillips slotted combination
- Finish: Zinc Plated
- Material: C1018 Hardened Steel
- Packaging: 100 pieces

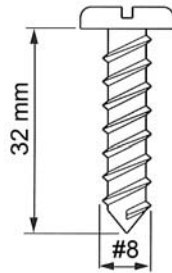

3873.009.098 ZINC PLATED

- Self tapping screw
- Pan head
- Material: C1018 Hardened Steel
- Packaging: 1,000 pieces

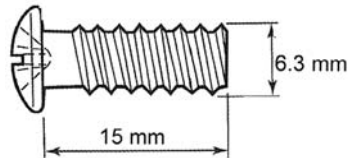

1203.001.098 ZINC PLATED

- Euro screw
- Pan head
- Material: C1008 Steel
- Packaging: 250 pieces

OTHER AVAILABLE STYLES

*Please contact us for detailed specifications on other levelers available by special order.
Minimum quantities apply.